

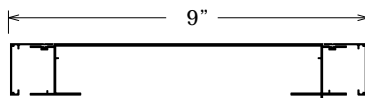

### Sign Cabinet Fillers with Econo Moldings

Large Double Face Filler  
Part #'s 2032 and 2056



Medium Double Face Filler  
Part #'s 2036 and 2056

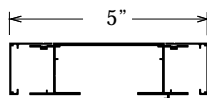

Single Face Filler  
Part #'s 2034 and 2056

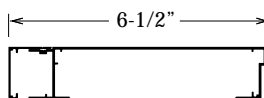

### Sign Cabinet Fillers with Extended Econo Moldings

Large Double Face Filler  
Part #'s 2032 and 2058

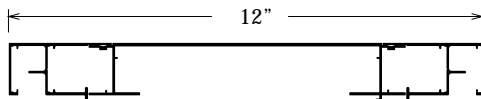

Medium Double Face Filler  
Part #'s 2036 and 2058

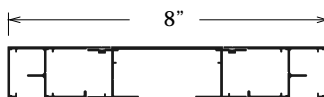

Single Face Filler  
Part #'s 2034 and 2058

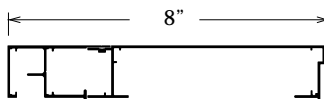

Medium Double Face Filler with Econo Molding  
Part #'s 2036 and 2056

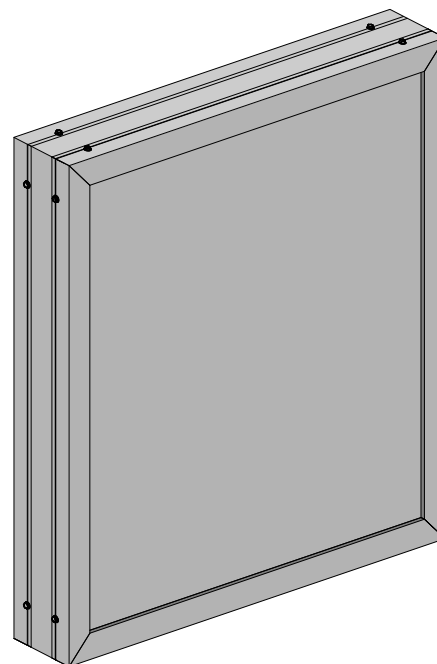
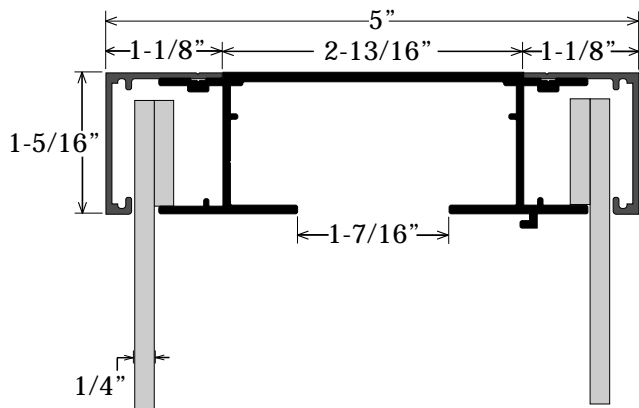

Available in cut to size kits and full length extrusions.